

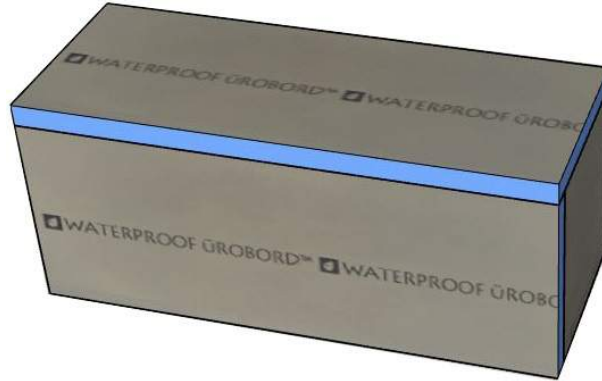

2" thick (50mm) Bench Instruction Manual



Required tools:



Tape Measure

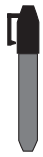

Marker / Pencil



Spirit Level



überseal™ spreading tool

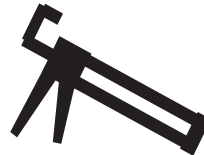

Caulking Gun

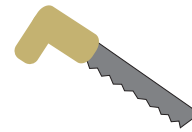

Handsaw or Circular Saw

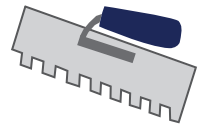

1/2"x1/2" sq Notched Trowel

Required materials:



Thinset Mortar
ANSI A118.4 / 118.5



überseal™ joint sealant

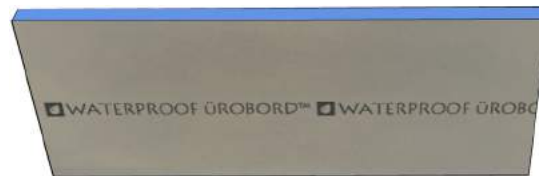

Urobord™ 2" (50mm) thick board



Roll Fibremesh

The information pertained within this guide is for reference only and does not supersede instructions from other product manufacturers or building codes. Always consult and follow manufacturers specific installation and safety instructions BEFORE installing any products. überseal™ bears no responsibility or liability for damage(s) resulting from the contents contained within this manual.

Substrate requirements:

- The walls behind the bench must be waterproofed and tile ready prior to bench installation
- The area underneath the bench must be properly waterproofed and sloped prior to bench installation
- The finished tiled bench top must be sloped a minimum 1/4" per foot to allow proper water drainage

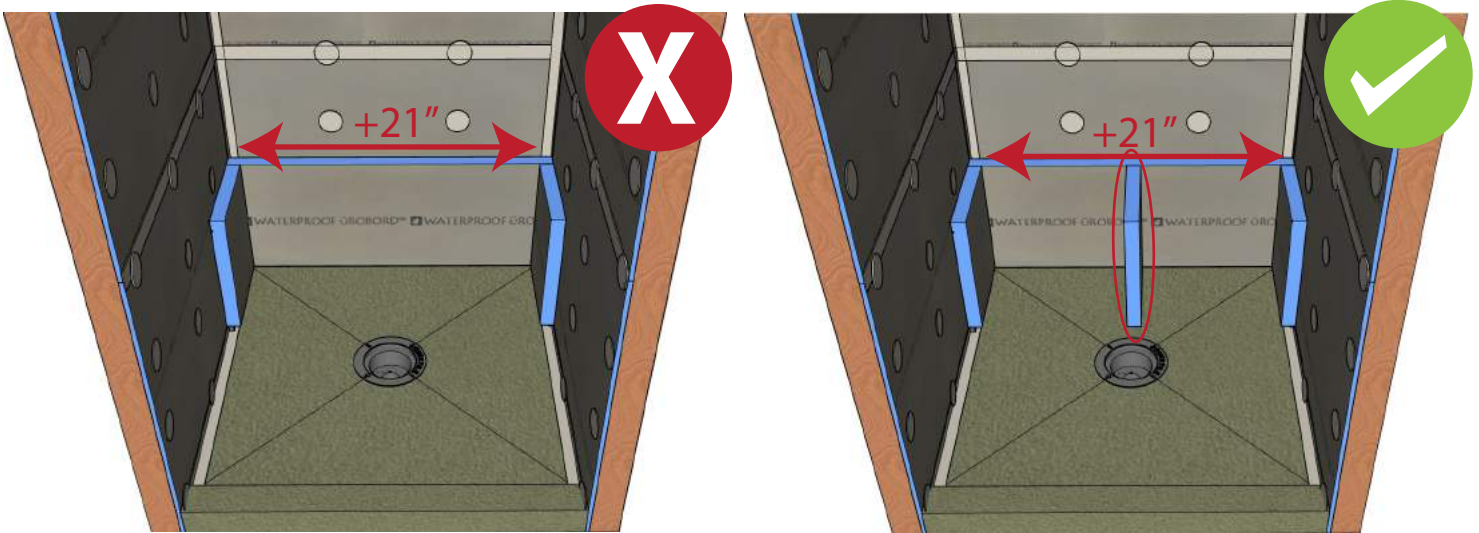

-A full vertical support made by using a full segment of **2" Board** must be installed for every 21" of bench length.

Cutting:

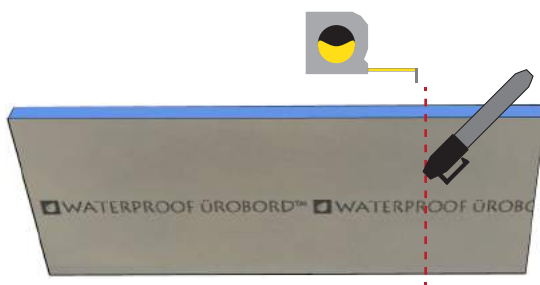

a) Measure the **board** and cut to length.

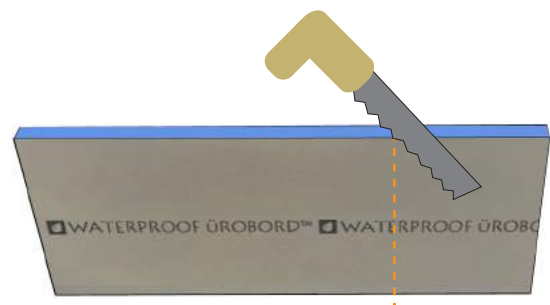

b)The **board** can be cut with a skill saw, table saw or hand saw.

Installation:

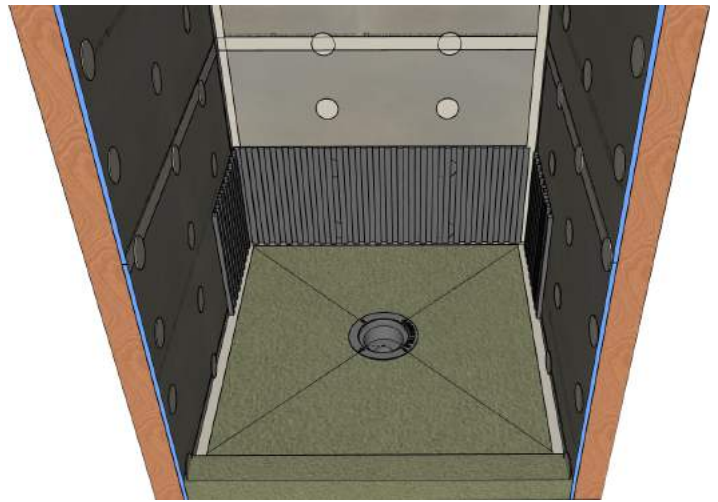
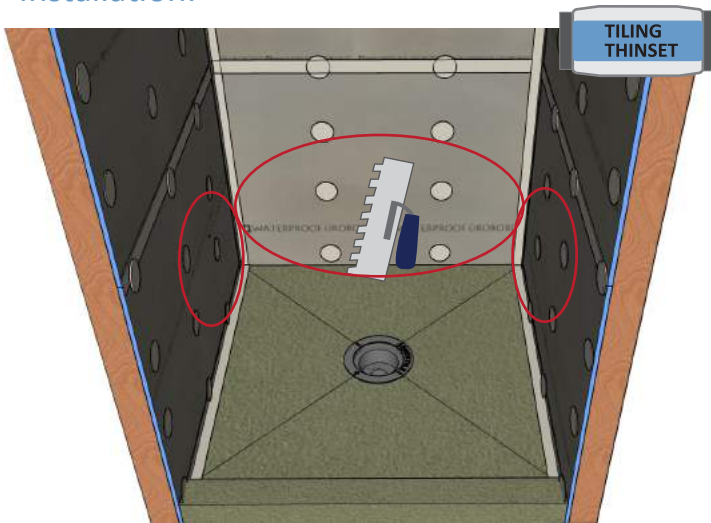

a) To fasten the **2" board** to the existing wall, apply **modified tiling thinset** onto the wall using a **1/2" x 1/2" sq. notch trowel**.

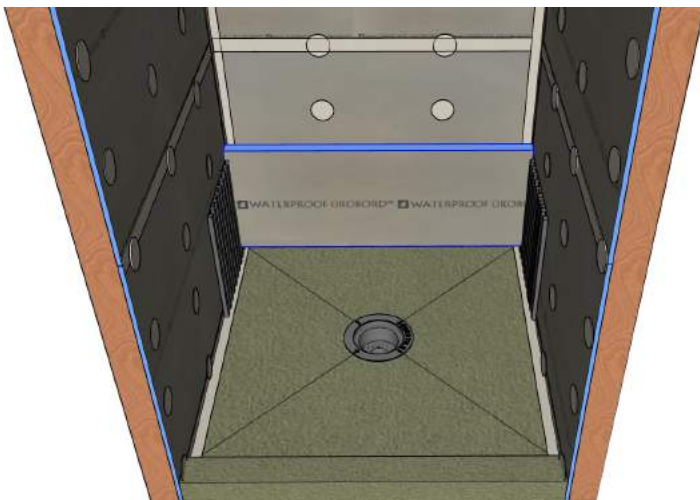

b) Install the first **2" board** directly into the **fresh modified tiling thinset**, embedding firmly.

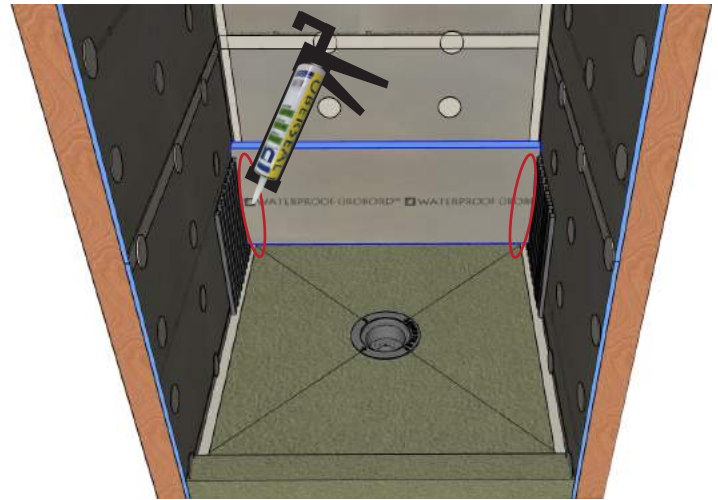

c) To join additional **2" board(s)**, first apply a generous bead of **Uberseal™ sealant** onto the area(s) where the **2" boards** will touch/intersect.

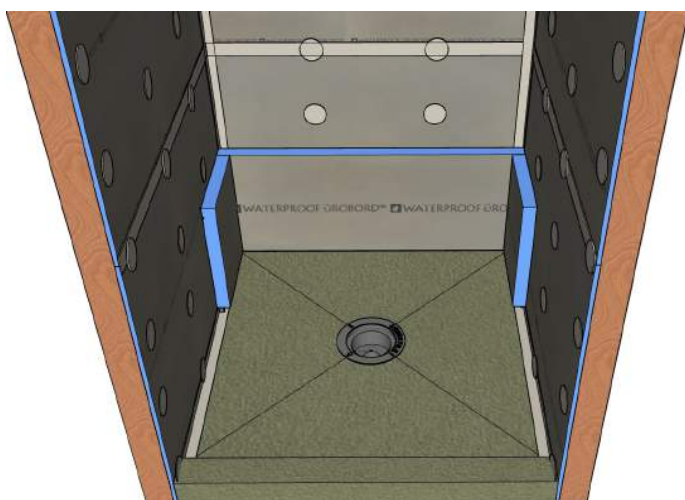

d) Press the **2" board(s)** into the fresh **Uberseal™ sealant**.

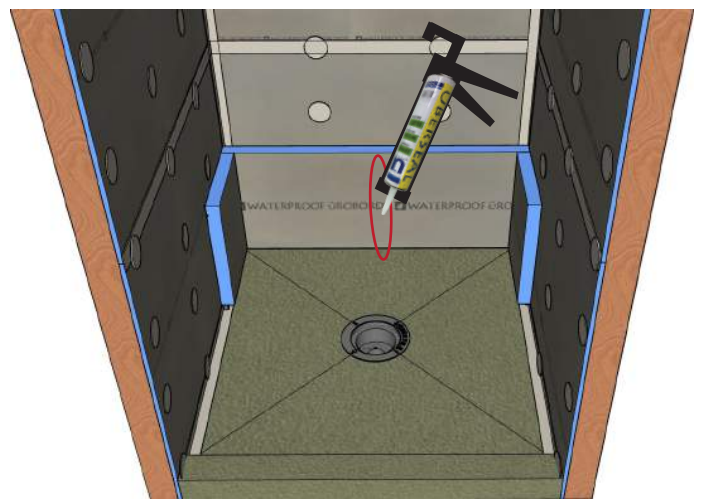

e) Repeat step c if adding a vertical support.

Installation: continued

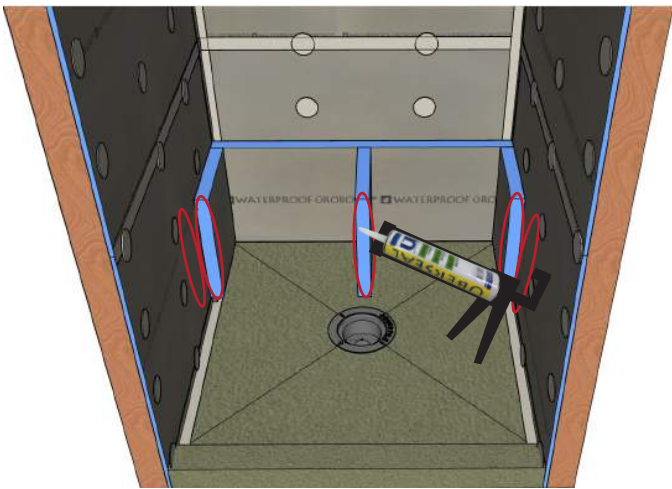

f) To adhere front **2" board**, repeat step c.

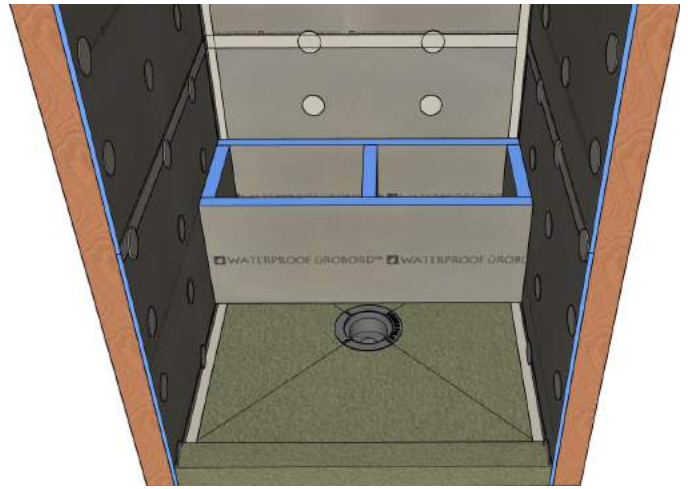

g) Press the **2" board(s)** into the fresh **Uberseal™ sealant**.

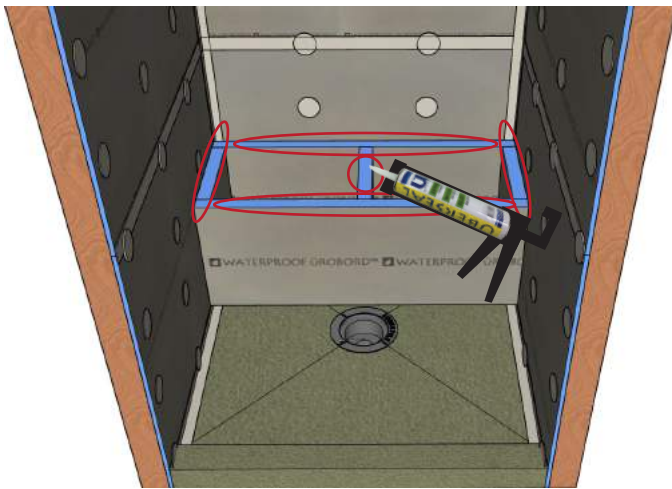

h) To adhere the top **2" board**, repeat step c.

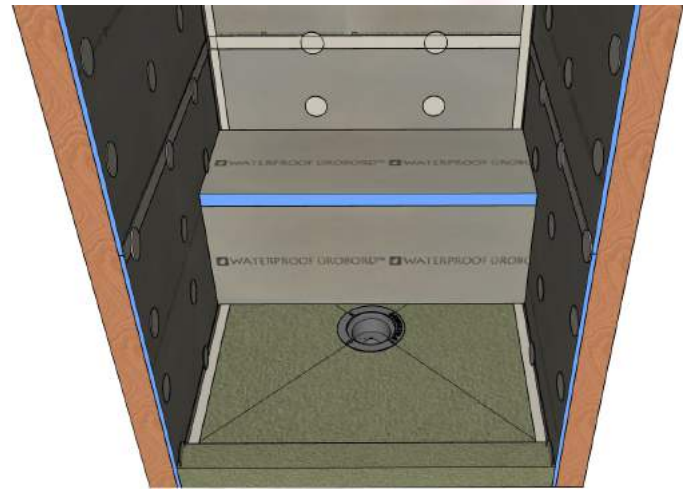

i) Press the **2" board** into the fresh **Uberseal™ sealant**.

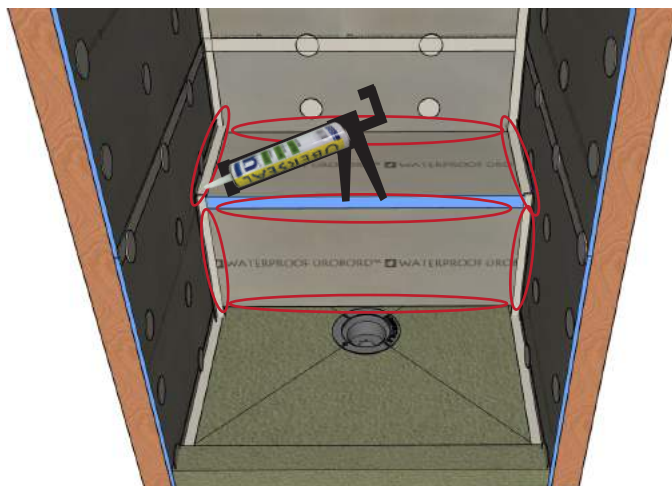

j) Apply a generous bead of **Uberseal™ sealant** to all perimeter area(s) of the bench.

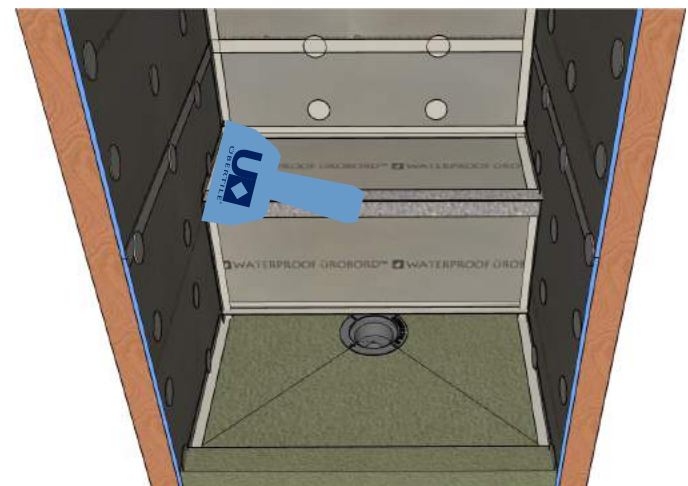

k) Using spreading tool, spread the fresh **Uberseal™ sealant** smooth and flat.

Installation: continued

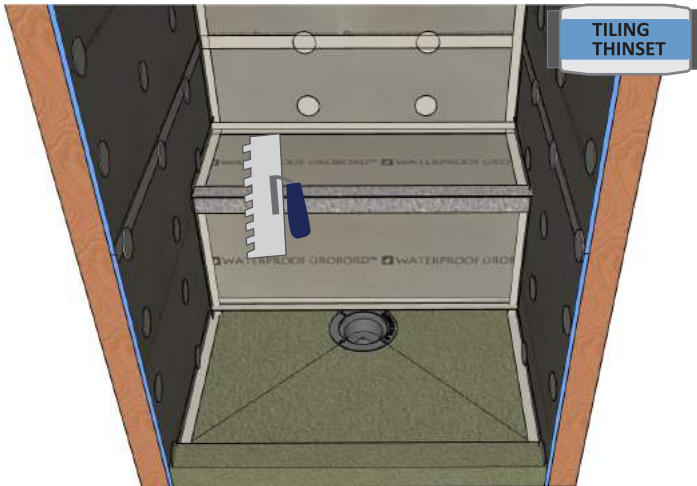

l) Apply **modified tiling thinset** to the exposed foam with the flat side of the trowel.

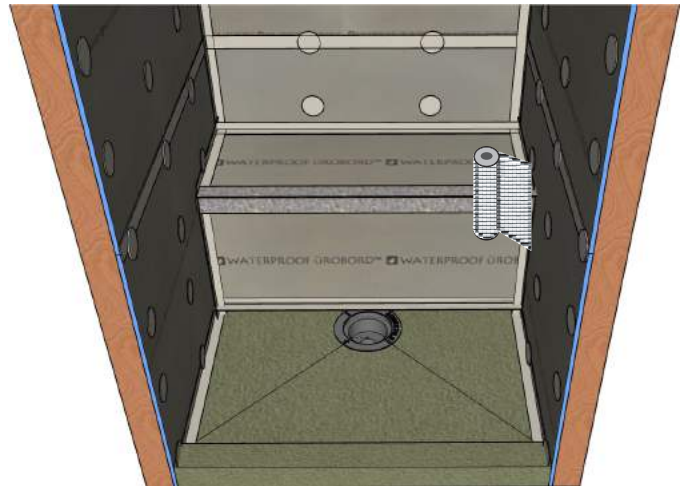

m) Apply **fibremesh tape** to the fresh **modified tiling thinset**.

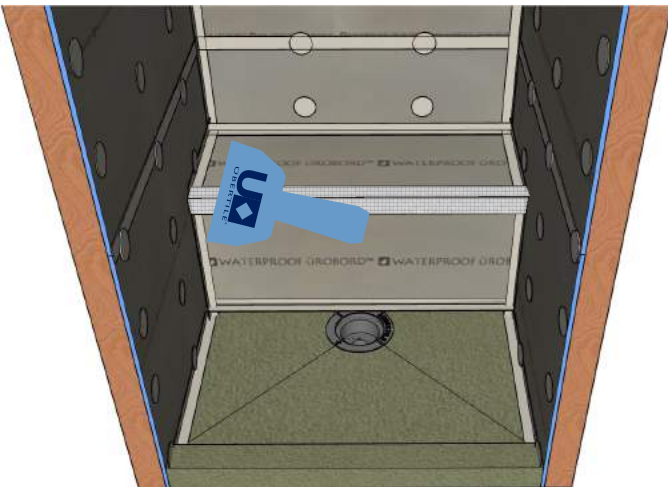

n) Embed / smoothout the **fibremesh tape** by tooling into the fresh **modified tiling thinset**.

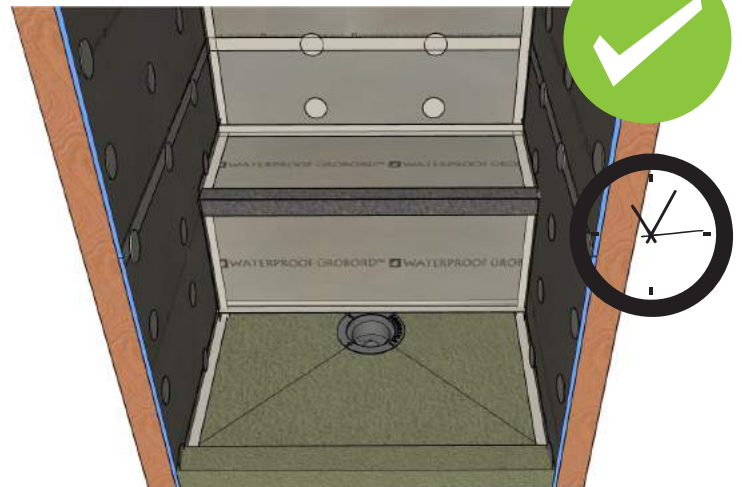

o) Wait 24 hours before tiling.