



Waterproof 2" Thick Bench Installation Manual



Manual Contents:

- 1.1P - Necessary Tools and Materials
- 1.2P - Substrate and Board Preparation
- 1.3P - Installation of Seat



scan for most current
installation manuals



WWW.UBERTILE.COM

The information pertained within this guide is for reference only and does not supersede instructions from other product manufacturers or building codes.

Always consult and follow manufacturers specific installation and safety instructions BEFORE installing any products.

übertile™ bears no responsibility or liability for damage(s) resulting from the contents contained within this manual.

Information may change without notice. Visit www.ubertile.com for most current revision.

All tasks performed by the product user are at the own risk and liability of the user.





2" thick (50mm) Bench Instruction Manual

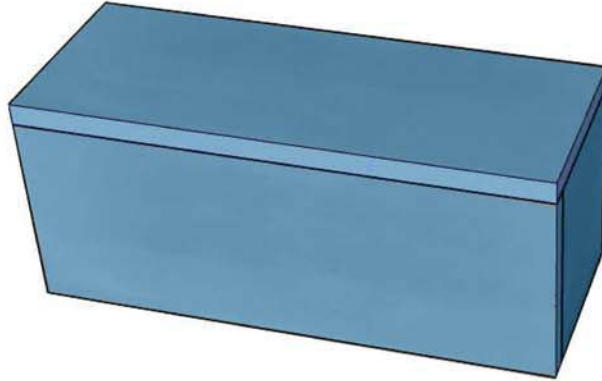

1.1P - Necessary Tools and Materials

Required tools:



Tape Measure



Marker / Pencil



Spirit Level



übersea™ spreading tool



Caulking Gun



Handsaw or Circular Saw

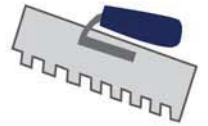

1/2"x1/2" sq Notched Trowel

Required materials:



Modified Thinset Mortar
ANSI A118.4 or A118.15



übersea™ for non-steam shower applications



Urobord™ 2" (50mm) thick board



Roll Fibremesh

The information pertained within this guide is for reference only and does not supersede instructions from other product manufacturers or building codes. Always consult and follow manufacturers specific installation and safety instructions BEFORE installing any products. übertile™ bears no responsibility or liability for damage(s) resulting from the contents contained within this manual.

1.2P - Substrate and Board Preparation

- The walls behind the bench must be waterproofed and tile ready prior to bench installation
- The area underneath the bench must be properly waterproofed and sloped prior to bench installation
- The finished tiled bench top must be sloped a minimum 1/4" per foot to allow proper water drainage

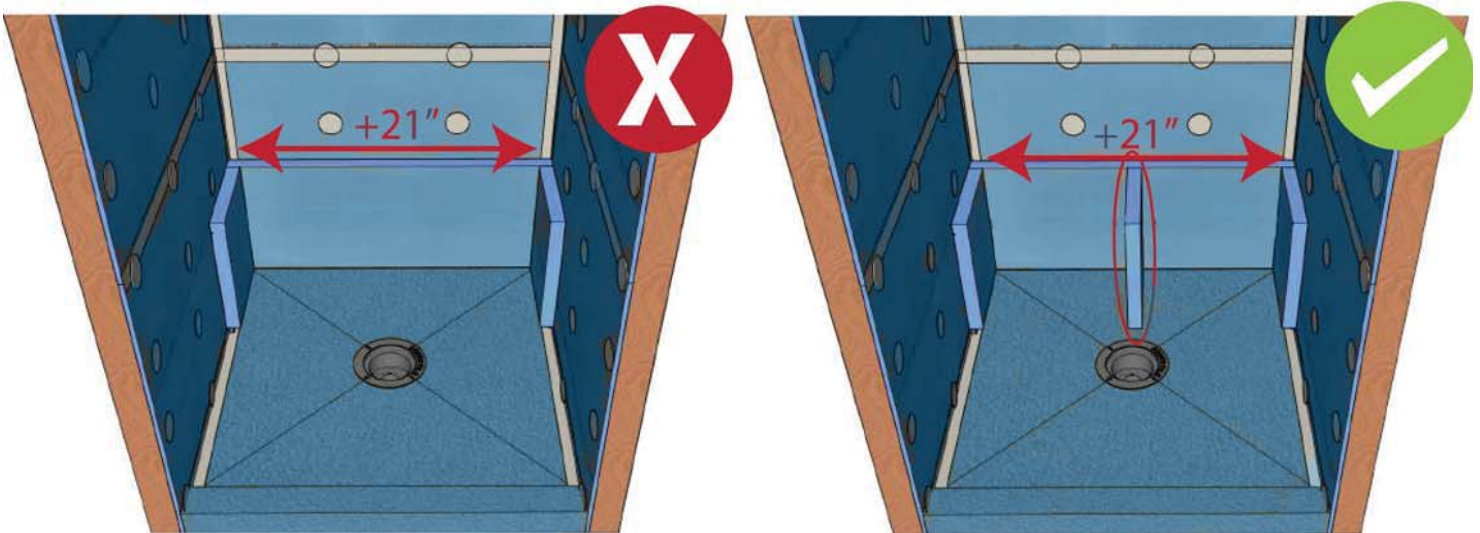

-A full vertical support made by using a full segment of **2" Board** must be installed for every 21" of bench length.

Cutting:

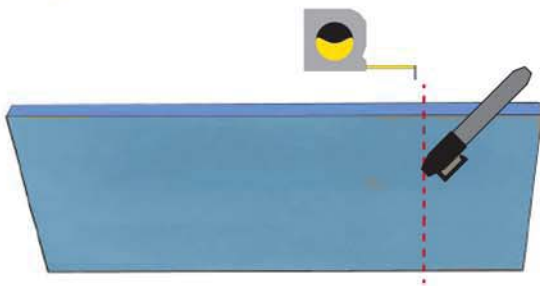

a) Measure the **board** and cut to length.

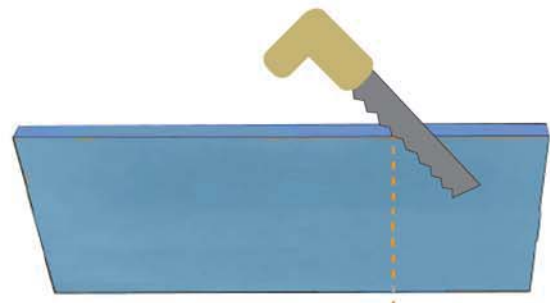

b)The **board** can be cut with a skill saw, table saw or hand saw.

1.3P - Installation of Seat

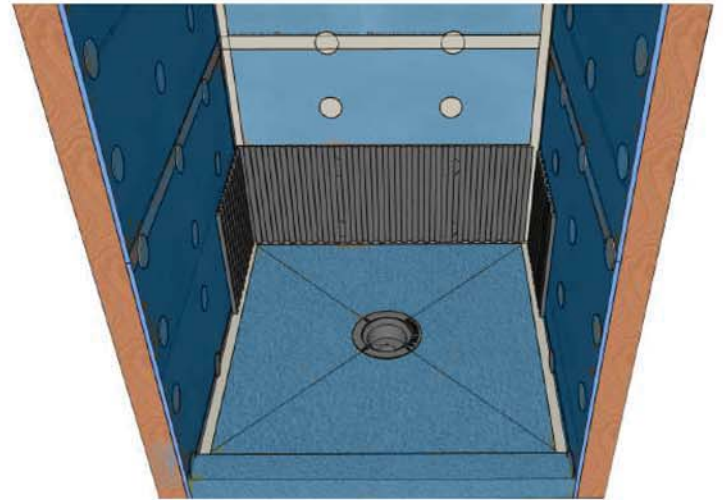
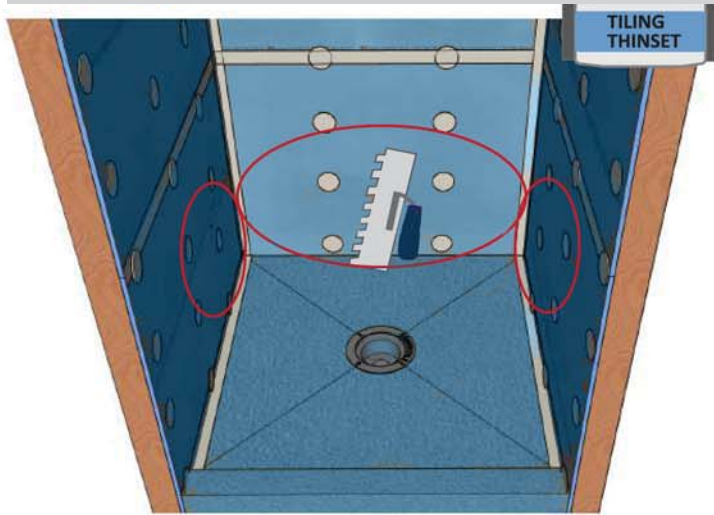

a) To fasten the **2" board** to the existing wall, apply **modified tiling thinset** onto the wall using a **1/2" x 1/2" sq. notch trowel**.

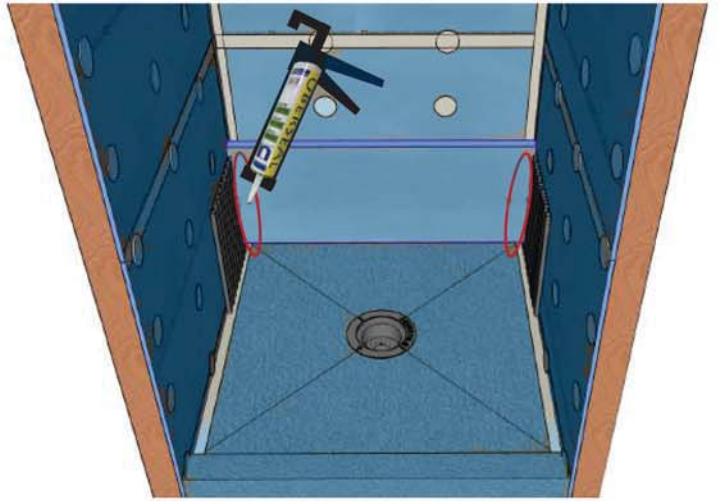
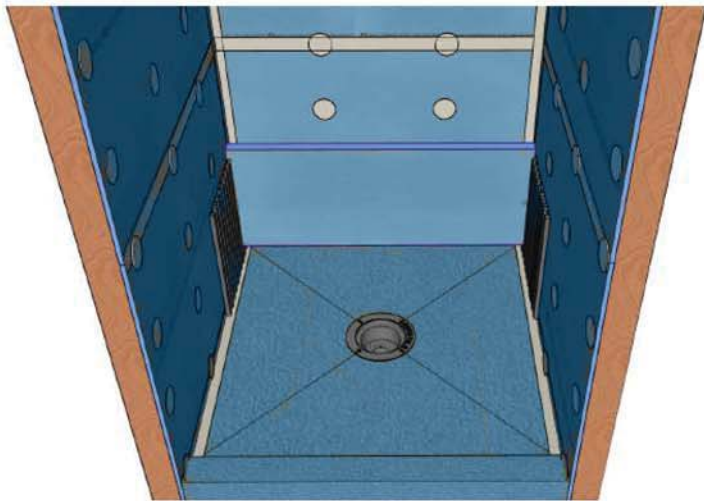

b) Install the first **2" board** directly into the **fresh modified tiling thinset**, embedding firmly.

c) To join additional **2" board(s)**, first apply a generous bead of **Uberseal™ sealant** onto the area(s) where the **2" boards** will touch/intersect.

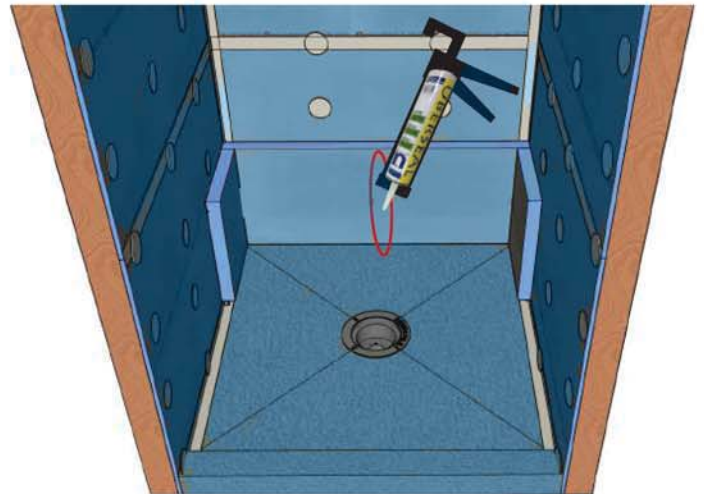
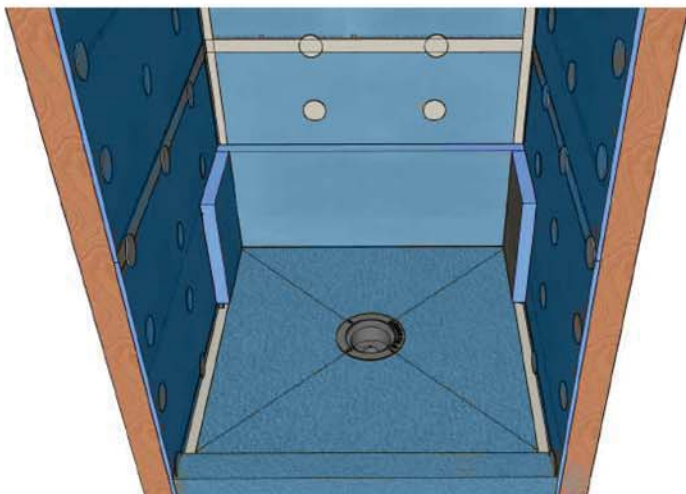

d) Press the **2" board(s)** into the fresh **Uberseal™ sealant**.

e) Repeat step c if adding a vertical support.

Installation: continued



f) To adhere front **2" board**, repeat step c.

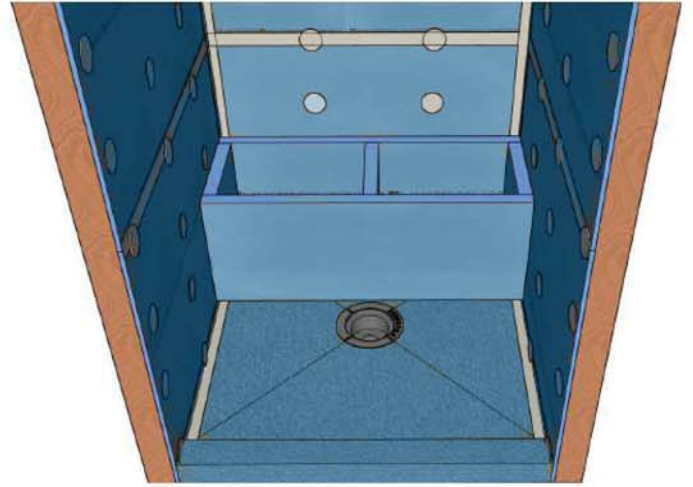

g) Press the **2" board(s)** into the fresh **Uberseal™ sealant**.



h) To adhere the top **2" board**, repeat step c.

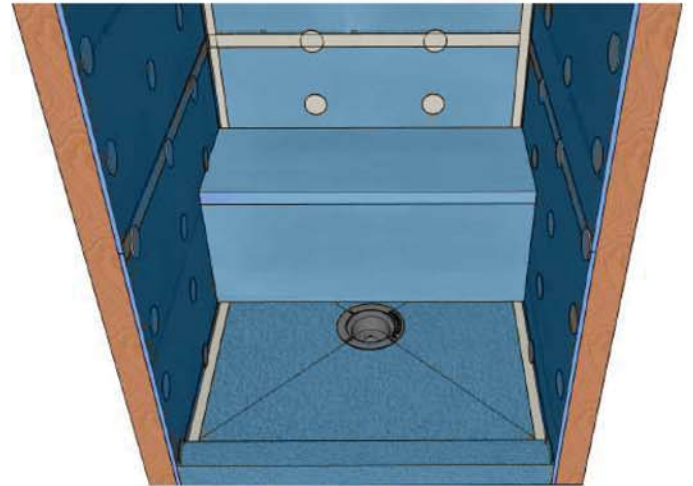

i) Press the **2" board** into the fresh **Uberseal™ sealant**.

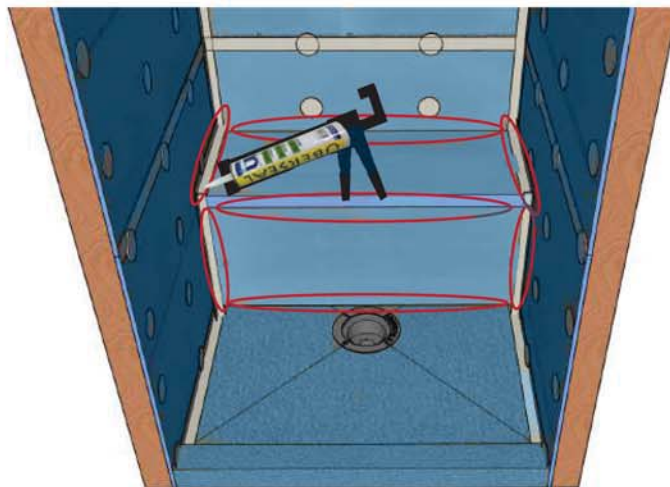

j) Apply a generous bead of **Uberseal™ sealant** to all perimeter area(s) of the bench.

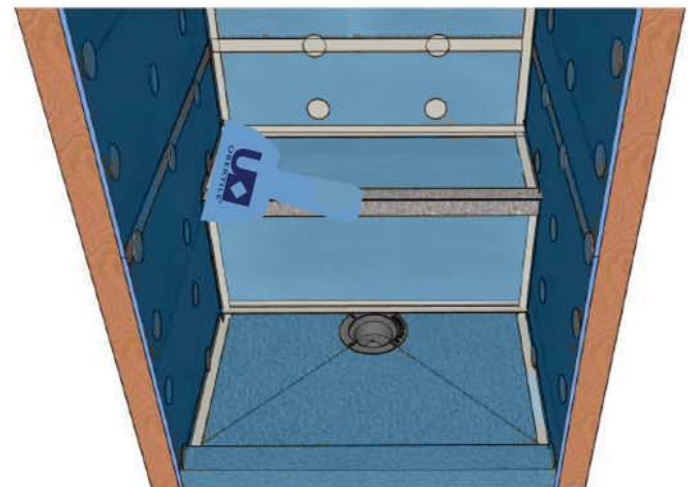

k) Using spreading tool, spread the fresh **Uberseal™ sealant** smooth and flat.

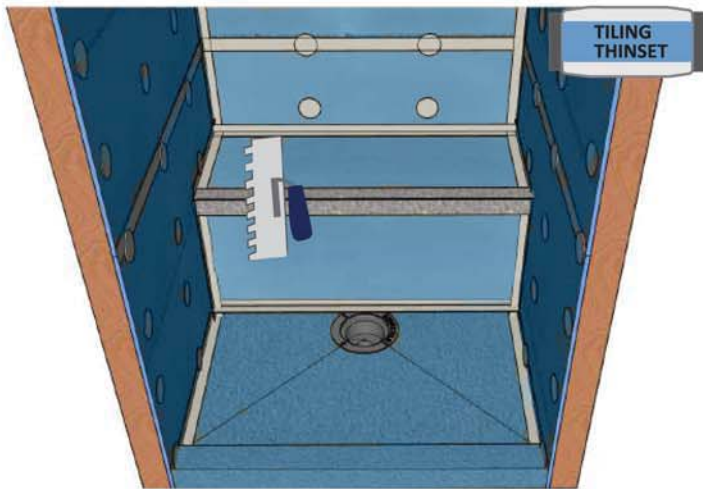

l) Apply **modified tiling thinset** to the exposed foam with the flat side of the trowel.

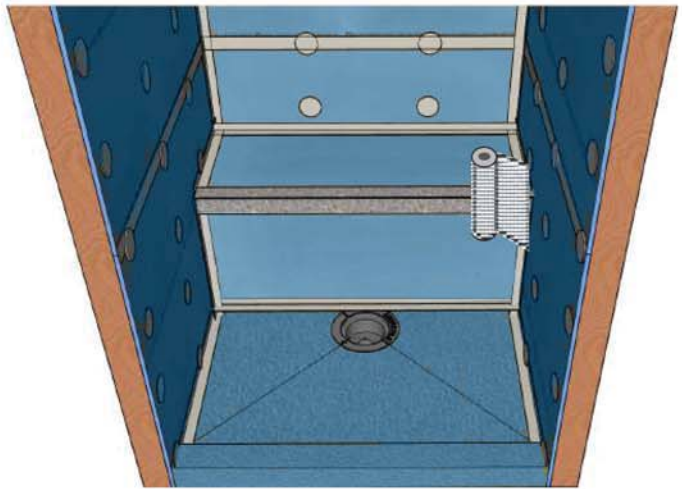

m) Apply **fibremesh tape** to the fresh **modified tiling thinset**.



n) Embed / smoothout the **fibremesh tape** by tooling into the fresh **modified tiling thinset**.



o) Wait 24 hours before tiling.