



Waterproof Tileable Niche



Installation Manual

Contents:
Section 1N
Niche

Required Materials (not Included)



Uberseal



Übertile Washers



Übertile Screws

Recommended Tools (not Included)



Level



Caulking Gun



Tape Measure



Flat Spreader



Power Drill

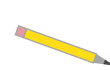

Marking Device



Utility Knife



WWW.UBERTILE.COM

The information pertained within this guide is for reference only and does not supersede instructions from other product manufacturers or building codes.

Always consult and follow manufacturer's specific installation and safety instructions BEFORE installing any products.

übertile™ bears no responsibility or liability for damage(s) resulting from the contents contained within this manual.

All tasks performed by the product user are at the own risk and liability of the user.

Visit www.ubertile.com for the most up to date instruction guides.

rev a 01-2020



Requirements Backing:

The Ubertile Shower Niche is intended to be installed only AFTER 1/2" Uberboard Waterproof wall panels have been installed. Studs must be 16" on center for the Niche to fit properly with a depth designed for minimum 2x4 studs (3.5" deep)

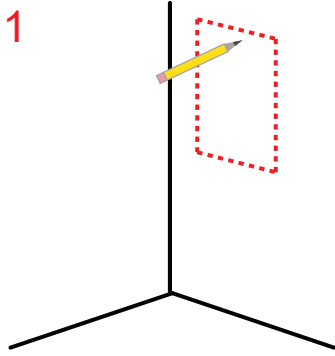

Mark onto the 1/2" UberBoard Wall Panel where your niche will be installed.

TIP: (Flip the niche up-side-down on the wall and trace the perimeter flange of the niche)

The markings must line up to the center of 16" O.C. stud-

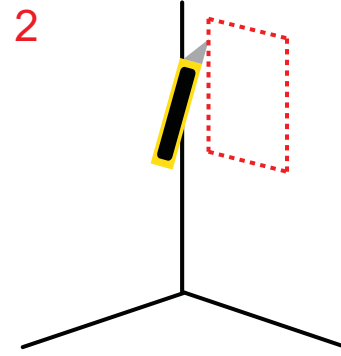

If necessary remove screws / washers in the cut path.

Carefully cut the UberBoard wall panel, and

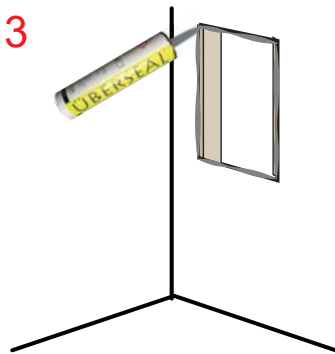

Apply Uberseal to the exposed foam edge of the UberBoard wall panel around the entire perimeter of the cutout.

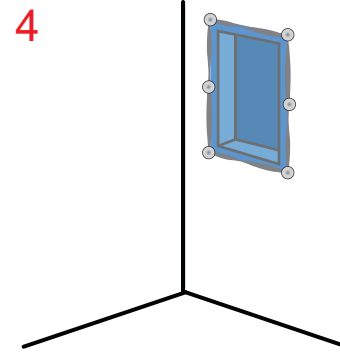

Use a minimum 6 Ubertile Screws and Washers to fasten the niche to the wall.

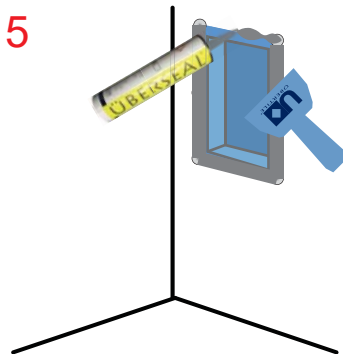

Apply Uberseal to the entire Niche perimeter. Ensure screws are covered fully. With the Uberseal fresh, smooth flat with spreader until a minimum 1" overlap of sealant is onto both Niche and Uberboard surfaces.

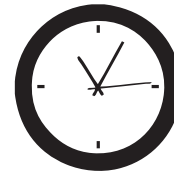

Depending on the model of Ubertile Niche, it may come with a height adjustable shelf.

To install the shelf:

Apply Uberseal to the back and sides of shelf.

Insert shelf into niche at desired height.

Spread out any excess Uberseal.

Wait 24 hours before tiling.